



BREAK-AWAY SWIVELS



U. S. Patent No. 4,687,365.

Break-Away Swivel

Essential for fiber optic and coaxial cable pulling, these swivels have a break load ranging from 150–1,800 pounds (667–8,006 N) and are designed to separate at $\pm 5\%$ of their rated break load. If the load rating is exceeded, the interior break pin fractures, the swivel separates, and the cable remains undamaged. Break pin is easily replaceable (see ordering information, next page).

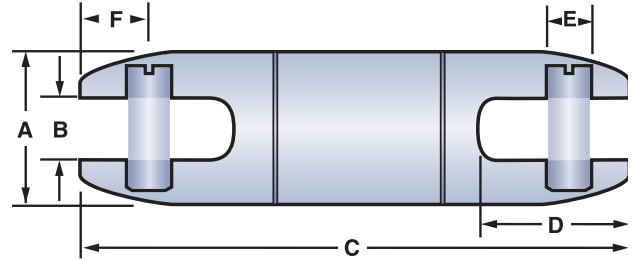

Break-Away Swivel Dimensions

| A | | B | | C | | D | | E | | F | |
|------|------|------|------|------|------|------|------|------|------|------|------|
| (in) | (mm) | (in) | (mm) | (in) | (mm) | (in) | (mm) | (in) | (mm) | (in) | (mm) |
| 5/8" | 16 | .28 | 7 | 3.56 | 90 | .79 | 20 | .25 | 6 | .37 | 9 |
| 7/8" | 22 | .38 | 10 | 4.51 | 115 | 1.06 | 27 | .31 | 8 | .53 | 13 |

! The 10% break tolerance zone for pins used in 5/8" (16mm) and 7/8" (22mm) diameter break-away swivels is $\pm 5\%$ of the nominal break load, called out along with the swivel diameter, in the description of the pin. For pins used in 1-1/4" (32mm) diameter or larger break away swivels, this zone shifts to $+8\% / -2\%$

NOTE: Swivels are not designed to run around bullwheels.

5/8" Swivel (16 mm)

| Part Number | Break Load | |
|-------------|------------|-------|
| | (LBS.) | (N) |
| 08017300 | 200 | 890 |
| 08017400 | 250 | 1,112 |
| 08017800 | 300 | 1,334 |
| 08016900 | 450 | 2,002 |
| 08017200 | 600 | 2,669 |
| 08017500 | 650 | 2,891 |
| 08017900 | 750 | 3,336 |

7/8" Swivel (22 mm)

| Part Number | Break Load | |
|-------------|------------|-------|
| | (LBS.) | (N) |
| 08018100 | 150 | 667 |
| 08018300 | 200 | 890 |
| 08018000 | 250 | 1,112 |
| 08017600 | 300 | 1,334 |
| 08018400 | 350 | 1,557 |
| 08075300 | 400 | 1,779 |
| 08015800 | 450 | 2,002 |
| 08076500 | 500 | 2,224 |
| 08018500 | 550 | 2,446 |
| 08015000 | 600 | 2,669 |
| 08018600 | 650 | 2,891 |
| 08076000 | 700 | 3,114 |
| 08075500 | 750 | 3,336 |
| 08018700 | 800 | 3,558 |
| 08018800 | 850 | 3,781 |
| 08076600 | 900 | 4,003 |
| 08015700 | 1,000 | 4,448 |
| 08018900 | 1,100 | 4,893 |
| 08015200 | 1,200 | 5,338 |
| 08019100 | 1,300 | 5,782 |
| 08074600 | 1,400 | 6,227 |
| 08076900 | 1,500 | 6,672 |
| 08019200 | 1,600 | 7,117 |
| 08019300 | 1,700 | 7,562 |
| 08017700 | 1,800 | 8,006 |